

NOTES:

- 1.) ALL UTILITY LOCATIONS MUST BE VERIFIED PRIOR TO ANY CONSTRUCTION ACTIVITY.
- 2.) ALL DISTURBED AREAS SHALL BE STABILIZED AS SOON AS POSSIBLE (SEE EROSION CONTROL NOTES BELOW).

EROSION CONTROL NOTES:

- 1.) THE SITE CONTRACTOR IS RESPONSIBLE FOR ESTABLISHING AND MAINTAINING SUITABLE EROSION AND SEDIMENTATION CONTROL DEVICES ON SITE DURING CONSTRUCTION AS REQUIRED, TO PREVENT SILT FROM LEAVING THE SITE. SILT WILL NOT BE ALLOWED BEYOND CONSTRUCTION LIMITS.
- 2.) EROSION CONTROL MEASURES SHALL BE MAINTAINED AT ALL TIMES. CONTRACTOR IS RESPONSIBLE FOR REPAIRING OR REPLACING EROSION CONTROL DEVICES WHICH BECOME INEFFECTIVE.
- 3.) CONTRACTOR SHALL OBTAIN ALL PERMITS FOR ALL GRADING AND OTHER LAND DISTURBING ACTIVITIES PRIOR TO CONSTRUCTION.
- 4.) THE CONTRACTOR IS RESPONSIBLE FOR THE CLEANUP AND REMOVAL OF ANY BUILDUP OF SEDIMENT WHICH ESCAPES FROM THE SITE. CONTRACTOR IS RESPONSIBLE FOR CLEANING SILT AND DEBRIS OUT OF ALL STORM DRAINAGE STRUCTURES UPON THE COMPLETION OF CONSTRUCTION.
- 5.) THE CONTRACTOR IS RESPONSIBLE FOR REMOVING ALL TEMPORARY EROSION CONTROL MEASURES AFTER CONSTRUCTION IS COMPLETE AND ALL DISTURBED AREAS HAVE BEEN STABILIZED.
- 6.) THE CONTRACTOR SHALL PROVIDE TEMPORARY GROUND COVER FOR ALL AREAS WITH EXPOSED SOIL WHICH WILL NOT BE DISTURBED BY GRADING OPERATIONS FOR A PERIOD OF THIRTY DAYS OR MORE. IF THE PROJECT IS SUSPENDED FOR ANY REASON, THE CONTRACTOR SHALL MAINTAIN THE SOIL EROSION AND SEDIMENTATION FACILITIES.
- 7.) SPRINKLE OR APPLY DUST SUPPRESSORS TO KEEP DUST LIMITED AT THE CONSTRUCTION SITE.
- 8.) TOPSOIL SHALL BE STRIPPED FROM ALL AREAS OF CONSTRUCTION AND STOCKPILED ON SITE. DO NOT REMOVE ANY TOPSOIL FROM SITE WITHOUT WRITTEN PERMISSION OF THE OWNER. TOPSOIL SHALL NOT BE STRIPPED FROM ANY AREA UNTIL IMMEDIATELY PRIOR TO THE EARTHWORK BEING PERFORMED.
- 9.) STOCKPILES SHALL BE SURROUNDED ON THEIR PERIMETERS WITH SILT FENCE TO PREVENT AND CONTROL SILTATION AND EROSION.

General Description
Short-term and Long-term
Operation & Maintenance

- For both short-term and long-term success of the Stormwater Management system, two concepts are critical.
1. Awareness of the system by all personnel authorized to access site and;
 2. Regular inspection and otherwise routine maintenance of the Stormwater Management systems being utilized on the site.

Informing personnel can be easily achieved by educating them. A generalized guide is attached for distribution by the designated control manager to all personnel.

The regular inspection and periodic maintenance of the system should be completed by the authorized personnel. This will ensure that the system will continue to function as designed over the long-term. Also, any area of the system that is compromised can be restored timely. In short these measures taken over time will avert an emergency condition.

Pavement sweeping

This non-structural source is necessary to remove potential point source pollutants accumulated during Winter / early Spring operations. All paved areas should be swept twice a year as a minimum, once in the Spring and once early in the fall. All accumulated debris shall be disposed of in accordance with local and state regulations.

Cultec Contractor 100 Chamber System

A maintenance and inspection schedule should be incorporated into the design to ensure the effectiveness of the Cultec Contractor 100 Chamber System. The frequency of cleanout is determined in the field after installation. During the first year of operation the chambers should be inspected monthly and cleaned as necessary. After the first year, the Chamber system should be inspected and cleaned every spring and fall.

DEP Snow Disposal Guidance

For snow plowing and snow removal, all efforts shall be made to avoid storing excessive amounts of snow in the drainage basin areas to help minimize unwanted sediment in forebays and drainage basins. Snow plowing shall consist of snow being pushed to the sides of the roadway and sidewalks.

Emergency Plan

Should a condition arise that compromises the operation of the stormwater system, or causes a potential to pollute the resource areas, a representative should contact the Cohasset Conservation Commission and the DEP. Interim measures should be taken as necessary and as follows.

Condition:

1. Spill of hazardous material should be contained and a hazardous materials removal company contacted for removal. DEP must be notified within 2 hours if more than 10 gallons of oil or hazardous liquids are spilled.
2. Any breach of the infiltration Basin should be restored by hand work if possible. Temporary erosion controls must be placed and a supply of silt-fence should be kept on site.
2. A follow-up with both the Cohasset Conservation Commission and the DEP should be made within twenty-four (24) hours to determine whether additional measures are necessary and/or additional regulatory filings are necessary.

OPERATION AND MAINTENANCE
SCHEDULE

THE APPLICANT AND OPERATOR RESPONSIBLE
FOR THE OPERATION & MAINTENANCE:
PAUL & TIFFANY HARRISON
46 BLACK ROCK ROAD
COHASSET

INFILTRATION BASIN MAINTENANCE SCHEDULE	
ACTIVITY	FREQUENCY
INSPECT INLETS AND OUTLETS FOR CLOGGING AND REMOVE ANY DEBRIS, AS REQUIRED	MONTHLY IN FIRST YEAR
INSPECT INLETS AND OUTLETS FOR CLOGGING AND REMOVE ANY DEBRIS, AS REQUIRED	SPRING AND FALL
INSPECT INLETS AND OUTLETS FOR CLOGGING AND REMOVE ANY DEBRIS, AS REQUIRED	ONE YEAR AFTER COMMISSIONING AND EVERY THIRD YEAR FOLLOWING

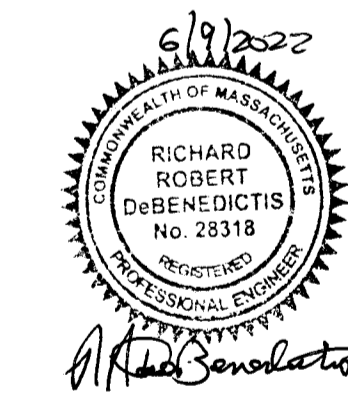
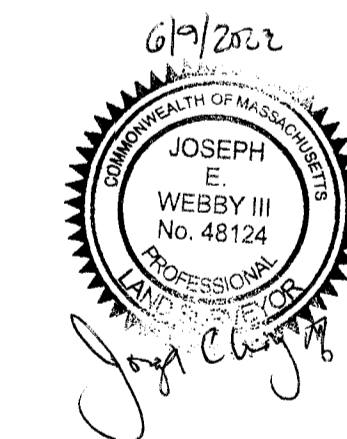

EROSION CONTROL
PLAN OF LAND
AT
46 BLACK ROCK ROAD
COHASSET, MASS.

PREPARED FOR
PAUL & TIFFANY HARRISON
SCALE: 1"=20' MAY 5, 2022 REV. 6/9/2022
WEBBY ENGINEERING ASSOCIATES, INC.
ENGINEERS & LAND SURVEYORS
180 COUNTY ROAD - PLYMPTON, MA.
02367 TEL. 1-781-585-1164