

NO.	DATE	DESCRIPTION	BY
1	12-23-21	ADDRESS CON. COMM. REVIEW COMMENTS	PJM

- NOTES:
- ZONING CLASSIFICATION – RESIDENCE C
 - THE LOCUS LIES IN ZONES X AND AE 10 AS SHOWN ON FIRM MAP COMMUNITY PANEL #250236 0118 E, REVISED JANUARY 19, 2018.
 - PLAN REFERENCES:
A) PLAN BOOK 170 PAGE 524
 - LOCUS DEED:
BOOK 39633 PAGE 32 RECORDED JULY 16, 2021.
ASSESSORS REFER: MAP 21 PARCEL 058
 - ANY AND ALL EXCESS SOIL FROM THE 5' x 10' ADDITION EXCAVATION SHALL NOT BE STOCKPILED ON SITE.
 - THERE IS NO PROPOSED CUTTING OF VEGETATION IN THE AREA OF THE PROPOSED ADDITION. A SMALL PORTION OF THE EXISTING LAWN WILL BE REPLACED BY THE PROPOSED ADDITION.
 - NO GRADE CHANGES ARE PROPOSED IN THE WORK AREA.

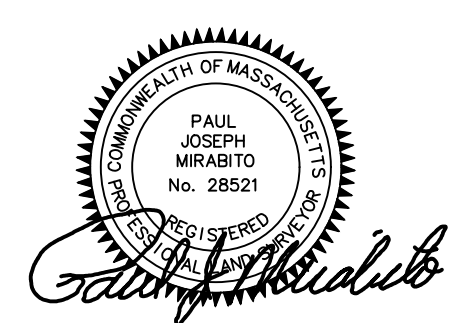

OWNER/APPLICANT
 RICHARD C. ERLER, III AND WENDY L. ERLER
 26 LITTLE HARBOR ROAD
 COHASSET, MA 02025

RDA PLAN
 FOR
 26 LITTLE HARBOR ROAD
 IN
COHASSET, MASS.

SCALE: 1"=20' DECEMBER 3, 2021
ROSS ENGINEERING COMPANY INC.
 PROFESSIONAL ENGINEERS – LAND SURVEYORS

683 MAIN STREET
 NORWELL, MASS. 02061
 (781)659-1325

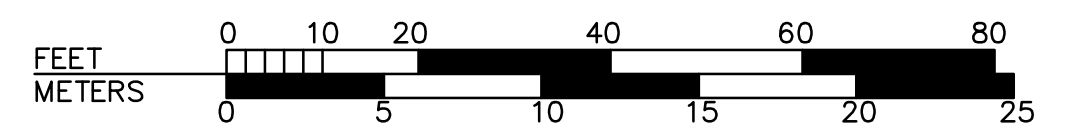

Q:\08514251-450014328-RDA.dwg, 12/23/2021 8:41:25 AM, DWG To PDF.pc3